

> Laboratory Platen Presses

LabEcon Specifications and Connections

Connections:

- A No Connection (See manual this is the CE data plate)
- B Waterinlet; (option)
- C Compressed air; (option)
- D Wateroutlet; (option)
- E Power: 3 x 400V+PE+N/50 Hz
Needs a female CEE 5 pole 6h IP44/54 wall socket.
Socket size and fuse size depending of the specifications for your press, see your order.

Single Plate power	Total installed power		
	2 Platen	3 Platen	4 Platen
3.2kW	16A	16A	32A
5.2kW	32A	32A	32A
6.0kW	32A	32A	64A
10.6kW	32A	64A	64A
12.2kW	64A	-	-
15kW	64A	-	-

Option;

	Single Daylight	Double Daylight
Water Supply	Pipe Ø12, M18x1,5 or Puch-Lock Hose DN10, Ø15,9x10	Pipe Ø15, M22x1,5 or Puch-Lock Hose DN12, Ø19,8x12
Air Supply	Pipe Ø12, M18x1,5 or Puch-Lock Hose DN10, Ø15,9x10	Pipe Ø15, M22x1,5 or Puch-Lock Hose DN12, Ø19,8x12
Water Outlet	Pipe Ø12, M18x1,5	Pipe Ø15, M22x1,5

When you use a pipe, at the picture on the right u can see the connection we use on the press. (we show the connection for a pipe Ø12mm)

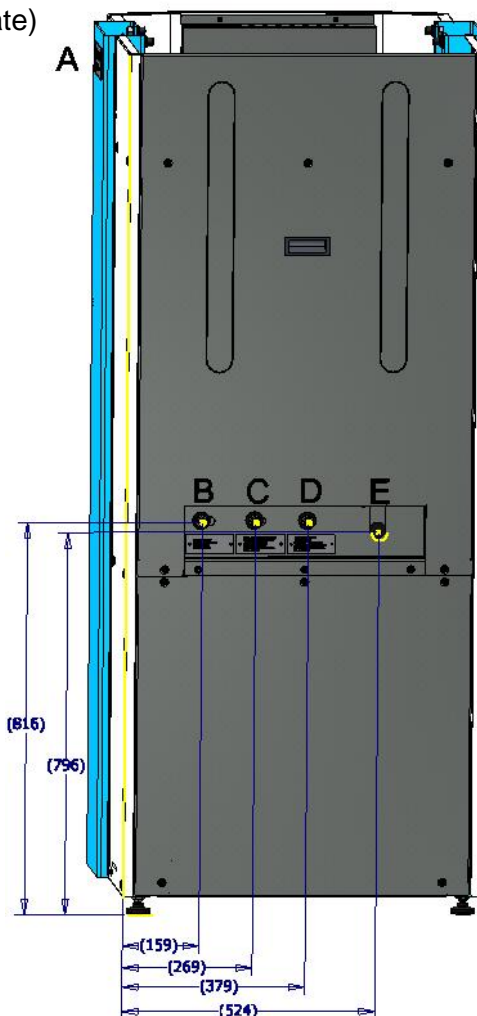
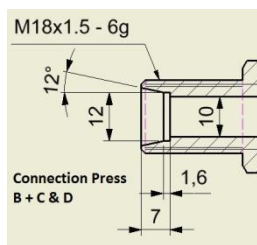

Water flowrate:

Flow is dependent on the water supply pressure.

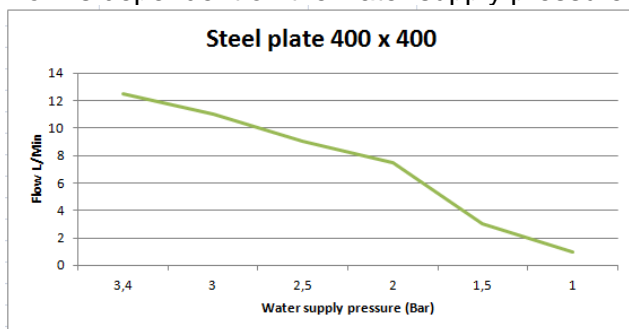

Maximum import and export of the water volume and the temperature dependent off the intense use on the machine cycle.

FONTIJNE
PRESSES
When quality matters

Fontijne Presses & Services BV
Ebweg 54, 2991 LT
Barendrecht, The Netherlands
Phone: +31 (0)180-20 30 52

www.fontijnepresses.com